

PRODUCT DATA SHEET

T5 Wedge base LED Lamp Replacement	WBL05XX-X
---	------------------

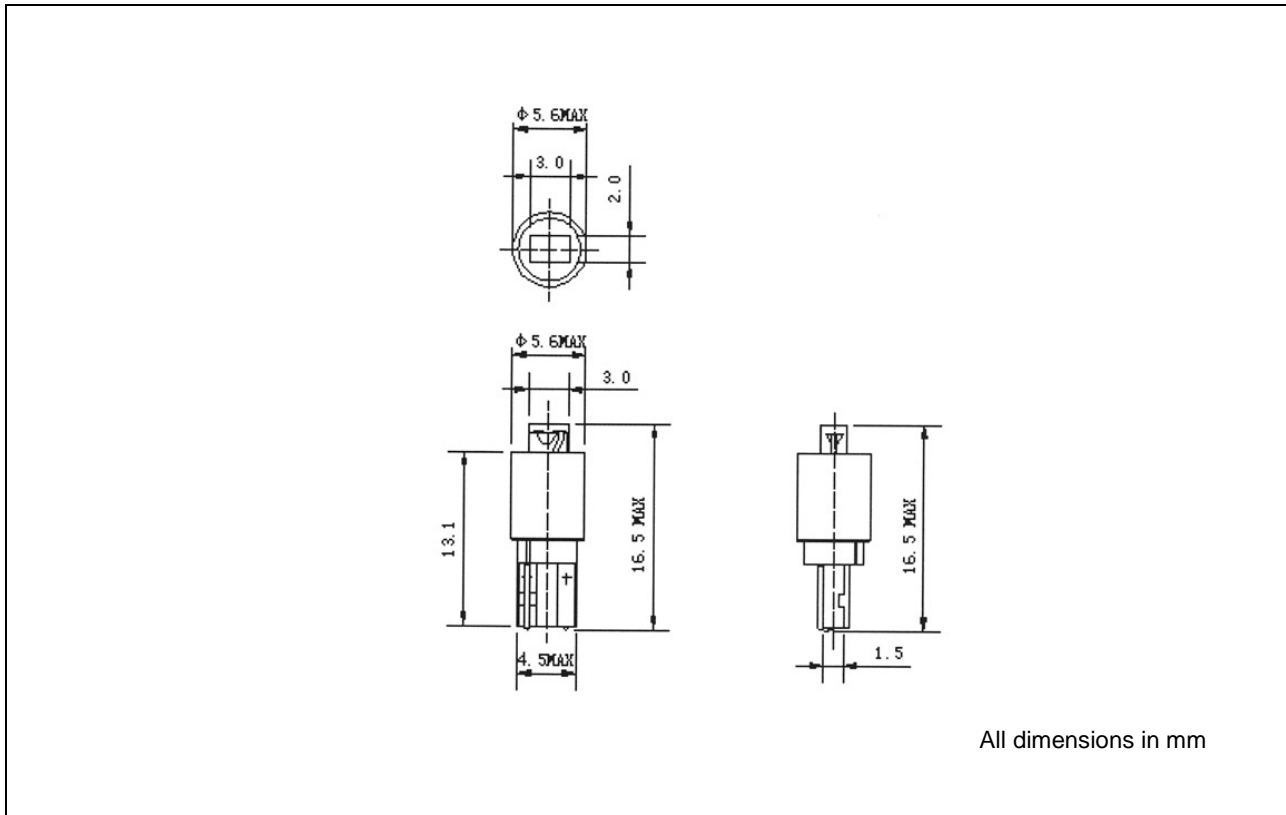

Electrical / Optical Characteristics @ Ta = 25°C

Part No.	Voltage (Vf)	Current (mA)	Power (mW)	Iv (mcd)		Colour Temperature °K	Viewing Angle
				Min.	Typ.		
WBL0506-9	6-8 VDC	14-18	84 - 144	300	500	5000 - 6000	120°
WBL0512-9	12-15VDC	14-18	168 - 270	300	500	5000 - 6000	120°
WBL0524-9	24-30VDC	12-16	288 - 480	300	500	5000 - 6000	120°

Operating temperature: -30°C ~ 85°C

Storage temperature: -40°C ~ 100°C

Operating life: 10,000 hours minimum to 70% of original brightness level.

Materials;

LED	3mm x 2mm rectangular flat top LED.
Resistor	2 resistors.
Moulding	Polybutylene Terephthalate – Colour; White.

Notes.

- 1) This device is polarity sensitive (polarity shown on base)
- 2) Marking ~ Plastic moulding to be durably marked with voltage “xxV” and polarity.
- 3) Wedge dimensions, holder-fit and construction to be compatible with W2x4.6d.
- 4) RoHS compliant.